

Data sheet | Item number: 890-1631

T-distribution connector; 4-pole; Cod. B; 1 input; 2 outputs; 2 locking levers;
gray

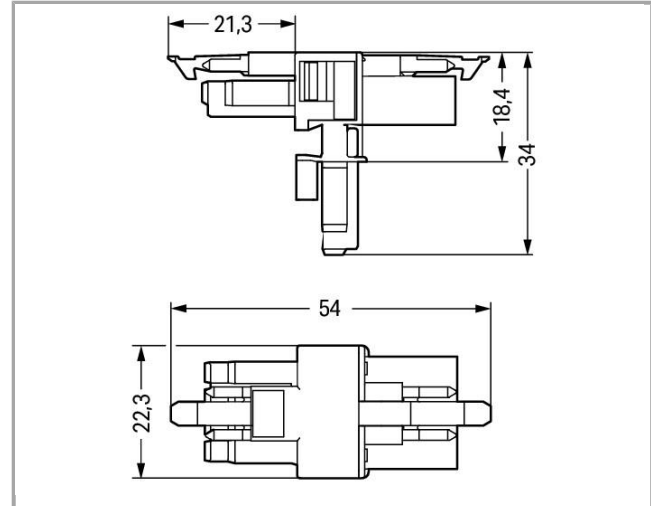

890-1631

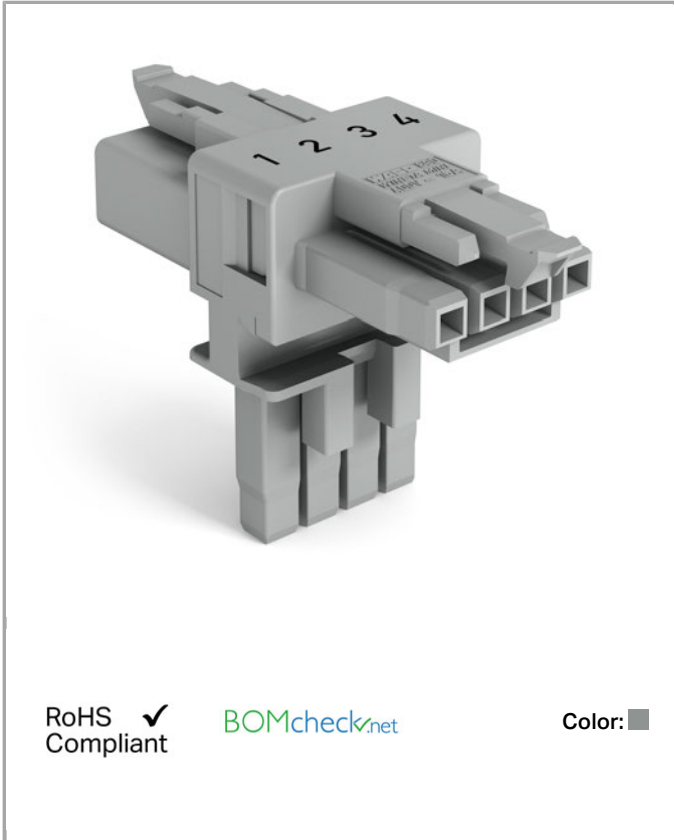

Item description

- Protected against mismatching and maintenance-free
- Compact design with 4.4 mm pole spacing
- Components can be clearly printed on and color-coded to meet custom requirements

Note:

All connectors for mounted installations (snap-in versions for lighting fixtures or devices, all types of PCB and distribution connectors) are factory-equipped with locking levers to ensure plugs and sockets are securely locked. Additional locking levers are only required for flying leads (plug /socket).

Safety information 1:

Application note for the U.S. market (USR): Some versions may also be used for current interruption in accordance with the UL certificate in select applications with currents below 5 A and voltages up to 600 V. For further information, please contact your local sales office.

Data**Electrical data**

Note on Contact Resistance	approx. 1m Ω contact resistance approx. 0.25m Ω contact transition plug/socket
----------------------------	--

Ratings per IEC/EN 60664-1

Rated voltage (III / 3)	400 V
Rated impulse voltage (III / 3)	6 kV
Rated current	16 A

Approvals per UL 1977

Rated voltage per UL 1977 (factory wiring only)	600 V
Rated current per UL 1977 (factory wiring only)	12 A

Connection data

Total number of potentials	4
No. of poles	4

Geometrical Data

Pin spacing	4.4 mm / 0.173 inch
Width	22.3 mm / 0.878 inch
Height	39.65 mm / 1.561 inch
Depth	53.9 mm / 2.122 inch

Mechanical data

Coding	B
Mating force of a plug-in connection	ca. 20 70 N (polzahlabhängig)
Retention force of a plug-in connection	When locked: > 80 N
Unmating force of a plug-in connection	ohne Verriegelung: ca. 20 70 N (polzahlabhängig)
Number of mating cycles	200, without resistive load 100, with resistive load $I_N = 16$ A, tested (1.5 mm ² /16 AWG)
Type of distribution connector	T-distribution connector
Marking	1 2 3 4
Protection class	IP20

Note on protection class

Only in mated condition (These compact connectors are not designed for use in open, easily accessible areas.)

Potential marking

1 2 3 4

Plug connection

Contact type (pluggable connector)

Socket/plug

Mismating protection

Yes

Locking of plug-in connection

locking lever

Locking lever

yes

Material Data

Color

gray

Insulating material

Polyamide 66 (PA 66)

Flammability class per UL94

V0

Contact material

Copper or copper alloy, surface-treated

Fire load

0.193 MJ

Weight

10.102 g

Environmental Requirements

Processing temperature

-5 +40 °C

Continuous operating temperature

-35 +85 °C

Note on Continuous Service Temperature

Insulating parts for temperatures ≤ 105 °C

Commercial data

Product Group

20 (WINSTA)

Country of origin

DE

GTIN

4050821799238

Customs Tariff No.

85366990990





Approvals / Certificates

Radio-Approvals



Logo	Approval	Additional Approval Text	Certificate name
	CB DEKRA Certification B.V.	IEC 61984	NL-47679
	CB DEKRA Certification B.V.	EN 61984	71-100413
	CCA DEKRA Certification B.V.	EN 60320	2148952.04



Country specific Approvals

Logo	Approval	Additional Approval Text	Certificate name
	CB DEKRA Certification B.V.	IEC 61984	NL-52879
	CB DEKRA Certification B.V.	EN 61984	71-100413
	CCA DEKRA Certification B.V.	EN 60320	2148952.04
	DNV GL Det Norske Veritas, Germanischer Lloyd	-	TAE00001Z6
	DNV GL Det Norske Veritas, Germanischer Lloyd	-	TAE00001Z6

Ship Approvals

Logo	Approval	Additional Approval Text	Certificate name
	DNV GL Det Norske Veritas, Germanischer Lloyd	-	TAE00001Z6
	LR Lloyds Register	EN 61535	08/20047 (E2)

Other Approvals

Logo	Approval	Additional Approval Text	Certificate name
	UL UL International Germany GmbH	UL 1977	E45171
	UL UL International Germany GmbH	UL 1977	E45171



Downloads

Documentation

Bid Text

890-1631	doc 23.0 kB	Download
----------	----------------	----------

CAD/CAE - Smart Data

CAD data

3D Download 890-1631	URL	Download
----------------------	-----	----------

Subject to changes.
